

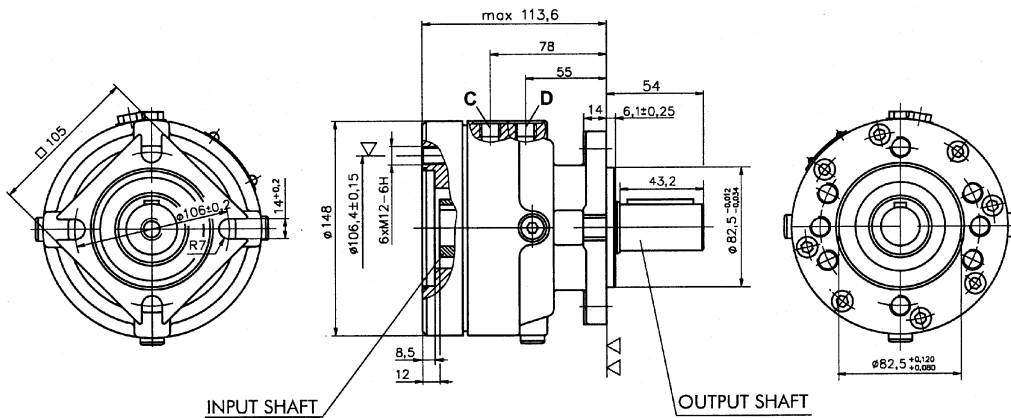

Lamellenremmen voor Orbitmotoren Freins pour moteurs orbitaux



C : Brake release Port - G $\frac{1}{4}$, 9 mm depth

D : Drainage tap - G $\frac{1}{4}$, 9 mm depth

▽,▽,▽ - Place for attachment
(tightening torque for bolts M12x30 - 8.8 DIN 931 - 7 daNm)

| Type | Koppel/Couple daNm | Openingsdruk bar Pression d'ouvert. | bar | cm ³ | cm ³ | bar | . |
|----------------|-----------------------|----------------------------------------|-----|-----------------|-----------------|-----|---|
| ELB/288 C 7 C | 6-8 | 4-5 | 300 | 7-8 | 50-120 | 0.5 | |
| ELB/288 C 14 C | 13-15 | 8-9 | 300 | 7-8 | 50-120 | 0.5 | |
| ELB/288 C 21 C | 20-22 | 12-13 | 300 | 7-8 | 50-120 | 0.5 | |
| ELB/288 C 32 C | 31-34 | 18-20 | 300 | 7-8 | 50-120 | 0.5 | |
| ELB/288 C 43 C | 41-45 | 24-26 | 300 | 7-8 | 50-120 | 0.5 | |